

PRODUCED IN CONJUNCTION WITH NEUDSIGN ARCHITECTURE, LLC. THIS DWG. AND ALL INFO. CONTAINED HEREIN, IS THE PROPERTY OF HANSEN-RICE, INC. ALL RIGHTS ARE EXPRESSLY RESERVED AND IT MAY NOT BE REPRODUCED IN WHOLE OR IN PART WITHOUT EXPRESSED WRITTEN CONSENT OF HANSEN-RICE, INC. THIS DWG. SHALL BE RETURNED TO HANSEN-RICE, INC. AT ITS REQUEST. © 2014 BY HANSEN-RICE, INC.

TABLE 5.106.5.2

TOTAL NUMBER OF PARKING SPACES	NUMBER OF REQUIRED SPACES
0-9	0
10-25	1
26-50	3
51-75	6
76-100	8
101-150	11
151-200	16
201 and over	At least 8 percent of total

100+ NEW SPACES = 11 LOW EMITTING, FUEL EFFICIENT or CARPOOL/VAN POOL SPACES SHALL BE DESIGNATED. PROVIDE PAINT AT DESIGNATED STALLS SO THAT LOWER EDGE OF THE LAST WORD ALIGNS WITH THE END OF THE STALL STRIPING (VISIBLE BENEATH A PARKED VEHICLE): "Clean Air/Vanpool/EV"

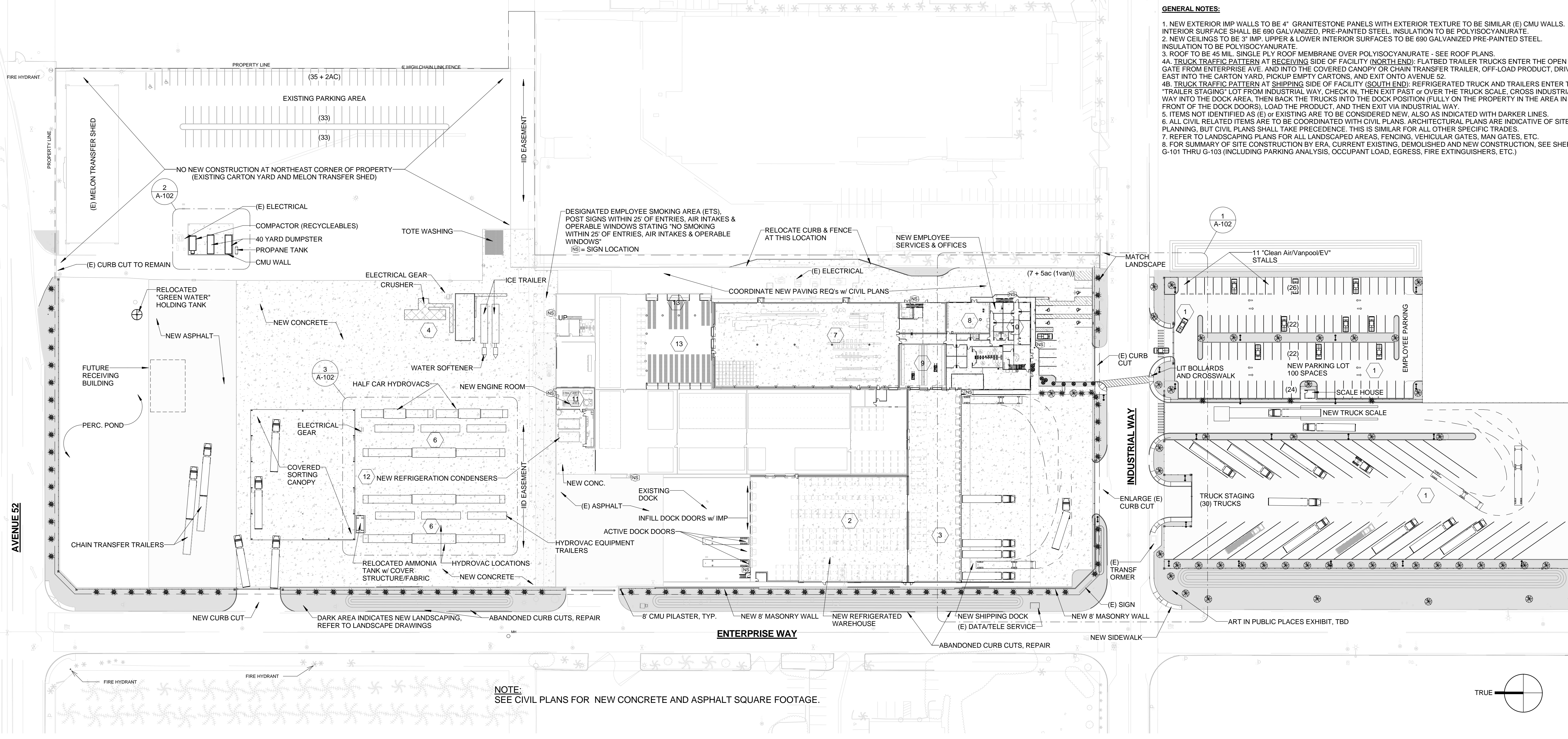

GENERAL NOTES:

1. NEW EXTERIOR IMP WALLS TO BE 4" GRANITESTONE PANELS WITH EXTERIOR TEXTURE TO BE SIMILAR (E) CMU WALLS. INTERIOR SURFACE SHALL BE 690 GALVANIZED, PRE-PAINTED STEEL. INSULATION TO BE POLYISOCYANURATE.
2. NEW CEILINGS TO BE 3" IMP. UPPER & LOWER INTERIOR SURFACES TO BE 690 GALVANIZED PRE-PAINTED STEEL. INSULATION TO BE POLYISOCYANURATE.
3. ROOF TO BE 45 MIL. SINGLE PLY ROOF MEMBRANE OVER POLYISOCYANURATE - SEE ROOF PLANS.
- 4A. TRUCK TRAFFIC PATTERN AT RECEIVING SIDE OF FACILITY (NORTH END): FLATBED TRAILER TRUCKS ENTER THE OPEN GATE FROM ENTERPRISE AVE. AND INTO THE COVERED CANOPY OR CHAIN TRANSFER TRAILER, OFF-LOAD PRODUCT, DRIVE EAST INTO THE CARTON YARD, PICKUP EMPTY CARTONS, AND EXIT ONTO AVENUE 52.
- 4B. TRUCK TRAFFIC PATTERN AT SHIPPING SIDE OF FACILITY (SOUTH END): REFRIGERATED TRUCK AND TRAILERS ENTER THE "TRAILER STAGING" LOT FROM INDUSTRIAL WAY, CHECK IN, THEN EXIT PAST or OVER THE TRUCK SCALE, CROSS INDUSTRIAL WAY INTO THE DOCK AREA, THEN BACK THE TRUCKS INTO THE DOCK POSITION FULLY ON THE PROPERTY IN THE AREA IN FRONT OF THE DOCK DOORS, LOAD THE PRODUCT, AND THEN EXIT VIA INDUSTRIAL WAY.
5. ITEMS NOT IDENTIFIED AS (E) or EXISTING ARE TO BE CONSIDERED NEW, ALSO AS INDICATED WITH DARKER LINES.
6. ALL CIVIL RELATED ITEMS ARE TO BE COORDINATED WITH CIVIL PLANS. ARCHITECTURAL PLANS ARE INDICATIVE OF SITE PLANNING, BUT CIVIL PLANS SHALL TAKE PRECEDENCE. THIS IS SIMILAR FOR ALL OTHER SPECIFIC TRADES.
7. REFER TO LANDSCAPING PLANS FOR ALL LANDSCAPED AREAS, FENCING, VEHICULAR GATES, MAIN GATES, ETC.
8. FOR SUMMARY OF SITE CONSTRUCTION BY ERA, CURRENT EXISTING, DEMOLISHED AND NEW CONSTRUCTION, SEE SHEET G-101 THRU G-103 (INCLUDING PARKING ANALYSIS, OCCUPANT LOAD, EGRESS, FIRE EXTINGUISHERS, ETC.)

PROFESSIONAL SEAL

DO NOT SCALE DRAWINGS
 CONTRACTOR SHALL VERIFY ALL CONDITIONS AND DIMENSIONS AT THE JOB SITE AND NOTIFY HANSEN-RICE, INC. OF ANY DIMENSIONAL ERRORS, OMISSIONS, OR DISCREPANCIES BEFORE BEGINNING OR FABRICATING ANY WORK.

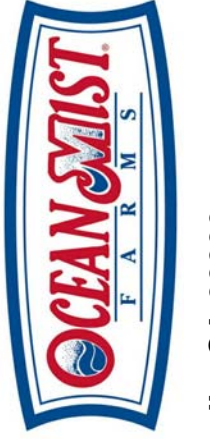

Ocean Mist Farms

52300 Enterprise Way, Coachella, CA 92236

Storage/Process Remodel & Add.
Site Plan - New

CLIENT / SHEET DESCRIPTION:

NO.	DESCRIPTION	DATE
A	Cont. Call 07-10-14	07/09/14
B	30% Review	07/18/14
C	40% Review	08/04/14
D	Pre-Application	08/04/14
E	Permit Update	08/22/14
F	60% Review	08/26/14
G	Rec. Line Updates	08/26/14
H	90% Review	09/22/14

DRAWN BY BAB	SHEET A-101
DATE 06/25/14	REV. H
SCALE @ 24"x36" 1" = 60'-0"	JOB NUMBER HRI-13568

1 Site Plan - New
 1" = 60'-0"

Note No	Note Content
1	FENCED IN EMPLOYEE PARKING AND TRUCK STAGING. INSTALL NEW TRUCK SCALE TO THIS AREA.
2	NEW COLD STORAGE WAREHOUSE. CONNECTS TO ROOM 3.
3	NEW SHIPPING DOCK. NEW CONSTRUCTION AND ROOM 1 RENOVATION.
4	RELOCATE ICE STORAGE BUNKER AND ICE INJECTION EQUIPMENT.
6	NEW LOCATION FOR HYDROVAC TUBES. SLOPE HYDROVAC SLAB TO DRAIN. (3) FULL CAR HYDROVACS & (2) HALF CAR HYDROVACS WILL BE INSTALLED.
7	VALUE ADD ROOM.
8	VALUE ADD EMPLOYEE WELFARE.
9	BATTERY CHARGING ROOM.
10	NEW OFFICES, 2 FLOORS.
11	CONSOLIDATE REFRIDGERATION EQUIPMENT AT NEW ENGINE ROOM AND INSTALL NEW NH3 PIPING AND EVAPORATORS THROUGHOUT THE FACILITY.
12	PROVIDE WASHDOWN STATIONS AT EACH HYDROVAC AND ICE INJECTOR. DRAINS AND SEWER AT EACH HYDROVAC, ICE GENERATORS AND ICE INJECTOR. CONDENSATE DRAINS AT EACH EVAPORATOR AND HVAC WITH DISCHARGE TO HUB DRAIN.
13	NEW FORCED AIR COOLERS.

9/22/2014 11:48:10 AM